

# *The O-FLEX Manufacturing Group Advantage*

*O-Flex Automotive, Inc.*

*Southeastern Anodizing Co., Inc.*

**Company Vision - Mission Statement:** O-Flex Mfg Group strives to be a Market Leader in providing our Customers with Innovative, Timely, Cost-Effective Manufacturing Solutions, across a diverse Customer Industrial Base, meeting their Ever-Changing requirements through a Commitment to Continuous Improvement in all we do, and sustaining a work Environment that fosters Teamwork, Trust, Respect and Open Communications.

---

**Organizational History:** Company Established 1921 in Tokyo, Japan by Ohtsuka Family  
Established North American Operations in 1996 supporting of Honda Operations  
Acquired 2 Metal Finishing Companies in 2006-2007  
World Wide Capabilities: 7 Mfg/Dist Facilities in TN, AL, China, Japan and Europe

---

**Product Strategies:** Aluminum Fabricator of Extrusions, specializing, but not limited to, Tubing  
**Products Primarily for Tier I, II & III Auto Customers. Current Projects include:**

- ❑ Impact Absorbing Tubes for Automotive and Packaging Applications
- ❑ Protective Sleeves for Thermal, Chemical, Electrical and Abrasion Applications
- ❑ Fabricated Alum Tubing for Air Bag Components, Hose Assemblies
- ❑ Brake Line Components for OEM and Aftermarket Applications
- ❑ HVAC and Conduit Tubing for Automotive and Construction Applications
- ❑ Competitive Source for Aluminum Extrusions of all Shapes and Sizes

---

**Services Strategies:** Full Service Metal Finishing, Value-Added Assemblies and Distribution Capabilities specializing, but not limited to Anodized Aluminum. **Current Process Capabilities:**

- ❑ 3 Anodizing Lines (lengths of 109", 120" & 480"); 200-R1 through 215-R5
- ❑ Type II and III (hard coat) Anodizing; all ROHS Compliant; meets MIL-A-8625F
- ❑ Bright Dip, Organic Dyes (Black), 2-Step-Electrolytic Coloring; Custom Coloring
- ❑ Chem Film (Alodine), Stainless Steel Passivation, Clear and Satin Coatings
- ❑ E-Coating, Zinc Phosphate, Powder Coating, and Heat Treating
- ❑ Robotic Buffing, Masking, Custom Rack Designs, Zinc, Copper, Nickel Electroplating
- ❑ Finished Assemblies shipped direct to Nissan, Toyota and Mercedes, among others
- ❑ Located in the Heart of the New Automotive Corridor; experienced with Exports
- ❑ Variety of Mechanical, Chemical Surface Prep and Treatment; Wet Painting

---

**Manufacturing Sites:**

1531 Sarah Court  
Murfreesboro, TN 37129  
(615) 898-1910

949 Esther Lane  
Murfreesboro, TN 37129  
(615) 898-1910

725 Keystone Drive  
Clanton, AL 35046  
(205) 755-3084





**Fabrication Capabilities:**

- 4 - CNC Vertical Machining Centers (3 Axis); 84" bed size capacity
- 4 - Metal Stamping/Punching Presses; up to 100 ton capability
- 3 - CNC Precision Cutting Machines; capable of holding +/- 0.1mm (.004")
- 2 - Manchester End Forming Machines: OD Capacity of 1.5", up to 3000 PSI
- 8 - Customized Winding Machines with Proprietary Shapers and precision cutters
- 1 - Chiyoda SP-15ST CNC Bender (.875"OD x .047"Alum; .625" OD x .062" Steel)
- 5 - Specialty Purpose Designed Machines (Lathes, Assembly Presses, etc.)
- 1 - Sheffield Discovery II CMM; PC Demis Software
- 1 - AXILA non-contact CMM
- 1 - Kuka Robotic Buffing Cell; Inter-Changeable End of Arm Tooling
- 3 - Manual and Automated Deburring Cells
- 1 - Department of Specialized Rack Tooling Experts

**Quality Mgmt Systems/Awards**

TS16949, ISO 9002 & ISO 14001 Certified by SAI Global  
 Certified Supply Source for Military and Aerospace Applications  
 8 - Years running of 100% on-time, reliable deliveries to customer schedules  
 4 - Years running of a Quality Reject Rating of 4 PPM or less  
 Honda: Delivery & Performance Awards; Intier: Perfect Delivery/Quality  
 Toyota: Value Improvement, Performance and Product Quality Awards  
 Both In-House Testing Capabilities and Certifications through 3<sup>rd</sup> Party Labs  
 Customer Dedicated R&D Group with Design and Simulation Experience

**Product Sampling**



Ford F-150 Rails



Heat Protection

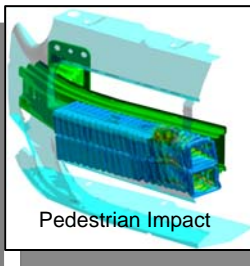

Pedestrian Impact

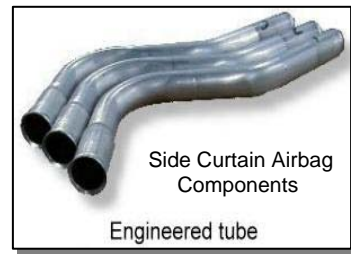

Side Curtain Airbag Components

Engineered tube



Energy Absorbing



Spring Lock Coupling



Nissan Cargo Systems

Bent Tube Assemblies

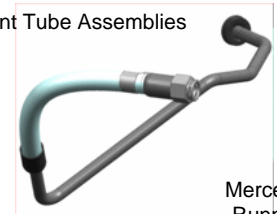

Mercedes Running Board Assmy



Customized Thermal Protection Sleeve

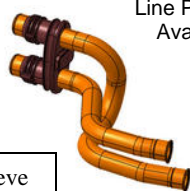

HVAC and Brake Line Products Available



Various Extrusion Sizes Available

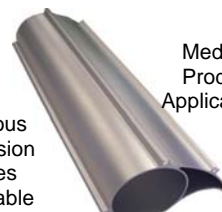

Medical Product Applications